

Ref: TT0008
V1.1

UDS - Environmental Learning Mode (ELM)

Related Products - BS-4000W, CS-3X00, FS-4000W, SS-4X00X & ST-2X00

Brigade recommends positioning the sensors where ELM is not required as it will create a dead zone around the sensor. Additionally, position the sensor and check detections before permanently fixing to the vehicle.



The ELM prevents false alarms from vehicle ancillary equipment, such as towbars.

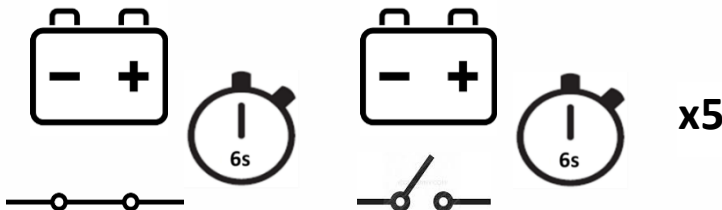
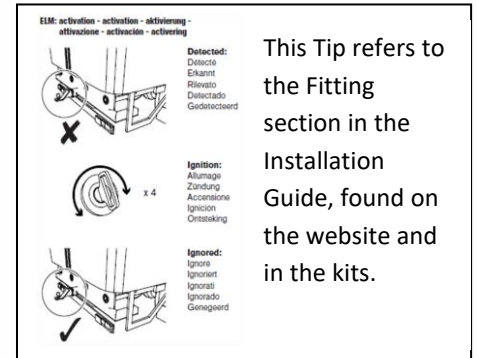

To activate ELM once the system has been installed, switch the power off and on 5 times, leaving 6 seconds between cycles. This will enable the system to recognise the ancillary equipment as part of the vehicle rather than an object to be detected.



Example of ancillary equipment probably too large for ELM to ignore.

Please note the ELM will not ignore the ancillary equipment if the obstacle being detected is too large. Excessive ultrasonic echo will result in constant detections rather than being ignored by the ELM. To rectify this the sensor may need relocating or the angle needs adjusting. *Please see Tech Tip - UDS Fixing Height and Angles Explained.*

