

Ref: TT0001
V1.0

UDS Fixing Height and Angles Explained

Related Products – BS-4000W, CS-3X00, FS-4000W, SS-4X00X & ST-2X00



Minimum sensor fitting height must not be less than 40cm from the ground. This prevents giving false detections caused by detecting the ground.

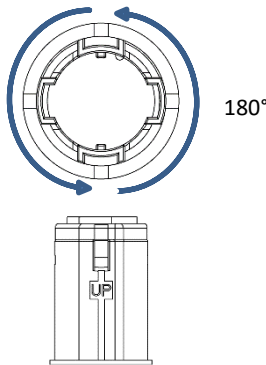
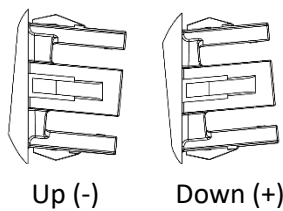
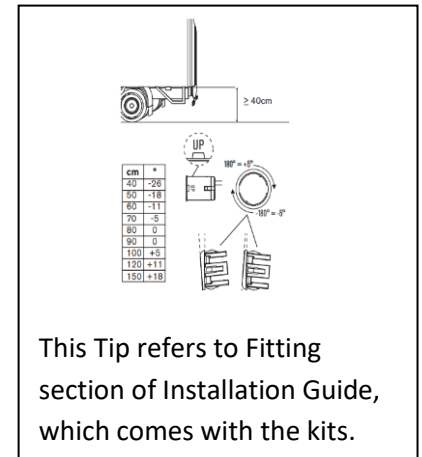

For the different sensor mounting heights, angled sleeves may be required to enable the sensor to work correctly without any false detections.

The sleeves can only be orientated through 180°, as the sensor must be fitted with the word UP on the top. There are five different angle sleeves, ranging from 0° to 26°. *See Table 1 for recommended sleeves.* The sleeve recommendations are assuming that the mounting surface is 90° to the ground. (Any mounting surface angle must be taken into consideration and sleeve angle may need to be increased/decreased accordingly).

Mounting Height (cm)	Recommended Sleeve	ID Mark
40	26° Up	F3
50	18° Up	F2
60	11° Up	F1
70	5° Up	F0
80	0°	F
90	0°	F
100	5° Down	F0
120	11° Down	F1
150	18° Down	F2

Table 1

Sleeve angles have been specified at the given heights for guidance. Heights between those shown may require testing with alternative sleeve angle to achieve optimum detection performance.

